

## Grooved × female threaded adapter elbow

Grooved × female threaded adapter elbow is a kind of elbow pipe fitting with a grooved connection at one end and an internal thread at the other end, which is used to connect grooved pipes with pipes or fittings with external threads

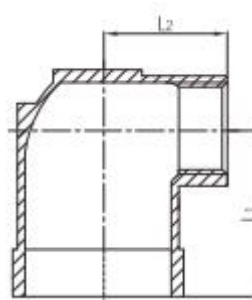

- **Standard:** ANSI / UL 213C UL / FM
- **Material:** Ductile iron ASTM A536, 65-45-12
- **Thread run:** Female thread, NPT / BSPT
- **Rated pressure:** 300 - 500 psi
- **Surface:** Red painting / hot dip galvanized
- **Size range:** 1-1/4"×1/2" - 2-1/2"×1"



Available size

Size			Center to end(mm)	
Inch	DN	mm	L1	L2
1-1/4" × 1/2"	32 × 15	42.4 × 21.3	45	31
1-1/4" × 3/4"	32 × 20	42.4 × 26.9	45	31
1-1/4" × 1"	32 × 25	42.4 × 33.7	49	32
1-1/2" × 1/2"	40 × 15	48.3 × 21.3	45	34
1-1/2" × 3/4"	40 × 20	48.3 × 26.9	45	34
1-1/2" × 1"	40 × 25	48.3 × 33.7	49	36
2" × 1/2"	50 × 15	60.3 × 21.3	45	40
2" × 3/4"	50 × 20	60.3 × 26.9	45	40
2" × 1"	50 × 25	60.3 × 33.7	49	42
2-1/2" × 1/2"	65 × 15	73.0 × 21.3	45	45
2-1/2" × 3/4"	65 × 20	73.0 × 26.9	45	45
2-1/2" × 1"	65 × 25	73.0 × 33.7	49	46