

Grooved 90° reducing elbow

Grooved 90° reducing elbow is a 90-degree reducing elbow with a grooved connection structure. The pipe diameters at both ends are different, which can not only change direction but also achieve pipe diameter reduction

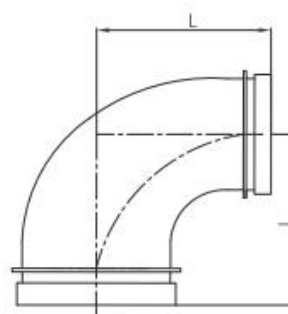

- Standard: ANSI / UL 213C UL / FM
- Material: Ductile iron ASTM A536, 65-45-12
- Rated pressure: 300 - 500 psi
- Surface: Red painting / hot dip galvanized
- Size range: 3"×2-1/2" - 6"×4"



Available size

Size			Center to end,L(mm)
Inch	DN	mm	
3"× 2-1/2"	80 × 65	88.9 × 76.1	108
4"× 2-1/2"	100 × 65	114.3 × 76.1	127
4"× 3"	100 × 80	114.3 × 88.9	127
6"× 4"	150 × 100	165.1 × 114.3	165
6"× 4"	150 × 100	168.3 × 114.3	165