

Grooved reducing flange tee wye

Grooved reducing flange tee wye is a pipe fitting with a grooved connection structure and a flange interface at one end. It is used for the diagonal branch of reducing pipelines and scenarios where flange connection is required

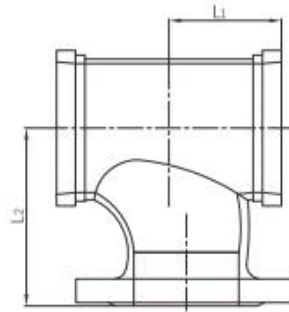

- **Standard:** ANSI / UL 213C FM
- **Material:** Ductile iron ASTM A536, 65-45-12
- **Rated pressure:** 300 - 500 psi
- **Surface:** Black / red painting / hot dip galvanized
- **Size range:** 4"×4"×2-1/2"



Available size

Size			Center to end(mm)	
Inch	DN	mm	L1	L2
4" × 4" × 2-1/2"	100 × 100 × 65	114.3 × 114.3 × 76.1	96	134.5