

Grooved straight cross (Equal cross)

Grooved straight cross (Equal cross) is an equal-diameter four-way pipe fitting. The four interfaces have the same pipe diameter and are vertically distributed in a cross shape, which is used to achieve cross-shaped branch connections of equal-diameter pipelines

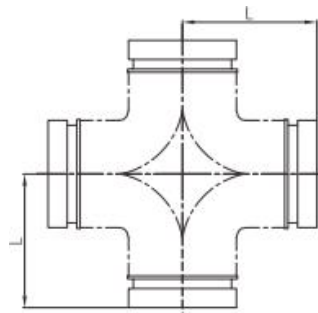

- **Standard:** ANSI / UL 213C UL / FM
- **Material:** Ductile iron ASTM A536, 65-45-12
- **Rated pressure:** 300 - 500 psi
- **Surface:** Red painting / hot dip galvanized
- **Size range:** 1-1/4" - 12"



Available size

Size			Center to end
Inch	DN	mm	L(mm)
1-1/4"	32	42.4	70
1-1/2"	40	48.3	70
2"	50	60.3	70
2-1/2"	65	73.0	76
2-1/2"	65	76.1	76
3"	80	88.9	86
4"	100	114.3	101
5"	125	139.7	124
5"	125	141.3	124
6"	150	165.1	140
6"	150	168.3	140
8"	200	219.1	175
10"	250	273.0	215
12"	300	323.9	254