

Grooved reducing cross with female threaded branch

Grooved reducing cross with female threaded branch is a reducing four-way pipe fitting. The interface with an internal thread design is used for cross-shaped branches of pipes of different diameters and connections of components that require internal thread mating

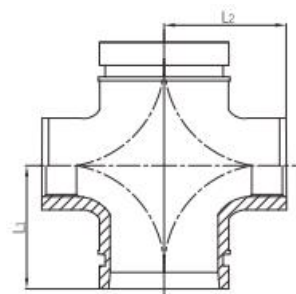

- Standard:** ANSI / UL 213C UL / FM
- Material:** Ductile iron ASTM A536, 65-45-12
- Branch:** Female thread, NPT / BSPT
- Rated pressure:** 300 - 500 psi
- Surface:** Red painting / hot dip galvanized
- Size range:** 2-1/2"×2" - 6"×3"



Available size

Size			Center to end(mm)	
Inch	DN	mm	L1	L2
2-1/2" × 2"	65 × 50	76.1 × 60.3	76	76
3" × 1-1/4"	80 × 32	88.9 × 42.4	86	86
3" × 1-1/2"	80 × 40	88.9 × 48.3	86	86
3" × 2"	80 × 50	88.9 × 60.3	86	86
4" × 1"	100 × 25	114.3 × 33.7	101	101
4" × 1-1/4"	100 × 32	114.3 × 42.4	101	101
4" × 1-1/2"	100 × 40	114.3 × 48.3	101	101
4" × 2"	100 × 50	114.3 × 60.3	101	101
4" × 2-1/2"	100 × 65	114.3 × 76.1	101	101
4" × 3"	100 × 80	114.3 × 88.9	101	101
6" × 1-1/4"	150 × 32	165.1 × 42.4	140	140
6" × 1-1/2"	150 × 40	165.1 × 48.3	140	140

Grooved reducing cross with female threaded branch

Available size

Size			Center to end (mm)	
Inch	DN	mm	L1	L2
6" × 2"	150 × 50	165.1 × 60.3	140	140
6" × 2-1/2"	150 × 65	165.1 × 76.1	140	140
6" × 3"	150 × 80	165.1 × 88.9	140	140