

Grooved eccentric reducer with female threaded outlet

Grooved eccentric reducer with female threaded outlet is an eccentric reducer with different diameters at both ends and a misaligned centerline, and the outlet end is designed with an internal thread. It is used to connect pipes of different diameters, to prevent fluid accumulation or gas blockage, and to fit internal threaded components

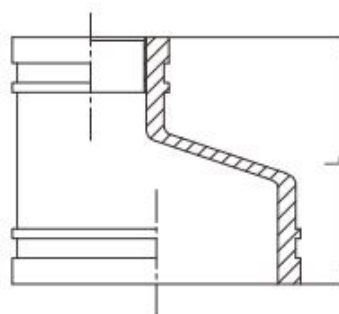

- **Standard:** ANSI / UL 213C UL / FM
- **Material:** Ductile iron ASTM A536, 65-45-12
- **Type:** Short / Standard
- **Branch:** Female thread, NPT / BSPT
- **Rated pressure:** 300 - 500 psi
- **Surface:** Red painting / hot dip galvanized
- **Size range:** 4"×2-1/2" - 6"×3"



Available size

Size			End to end
Inch	DN	mm	L(mm)
4" × 2-1/2"	100 × 65	114.3 × 76.1	102
5" × 3"	125 × 80	139.7 × 88.9	127
6" × 3"	150 × 80	165.1 × 88.9	140