

Malleable cast iron reducing tee (Equal minor run and branch)

This malleable cast iron reducing tee with equal - sized minor run and branch offers precise flow division, high adaptability, and reliable connection.

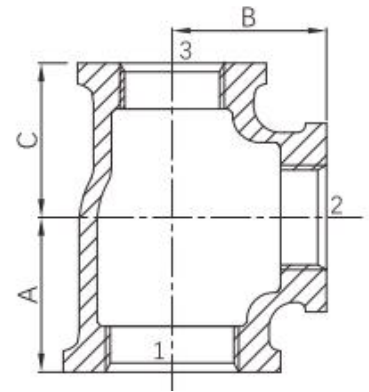

- **Standard:** ISO 49 / EN 10242
UL/FM
- **Material:** BS EN 1562, EN-GJMB-350-10
- **Thread:** BSPT
- **W. pressure:** 20 ~ 25 bar, ≤ PN25
- **Surface:** Black iron / hot dip galvanized
- **Size Range:** 3/4" x 1/2" x 1/2" --- 3" x 2" x 2"



Available size

SIZE(1 x 3 x 2)			A	B	C
INCH	DN	MM	MM	MM	MM
3/4" x 1/2" x 1/2"	20 x 15 x 15	20 x 15 x 15	30	31	28
1" x 1/2" x 1/2"	25 x 15 x 15	25 x 15 x 15	32	34	28
1" x 3/4" x 3/4"	25 x 20 x 20	25 x 20 x 20	35	36	33
1-1/4" x 1/2" x 1/2"	32 x 15 x 15	32 x 15 x 15	34	38	27
1-1/4" x 3/4" x 3/4"	32 x 20 x 20	32 x 20 x 20	36	41	33
1-1/4" x 1" x 1"	32 x 25 x 25	32 x 25 x 25	40	42	38
1-1/2" x 3/4" x 3/4"	40 x 20 x 20	40 x 20 x 20	38	43	32
1-1/2" x 1" x 1"	40 x 25 x 25	40 x 25 x 25	42	46	38
1-1/2" x 1-1/4" x 1-1/4"	40 x 32 x 32	40 x 32 x 32	46	48	45
2" x 1" x 1"	50 x 25 x 25	50 x 25 x 25	44	51	38
2" x 1-1/4" x 1-1/4"	50 x 32 x 32	50 x 32 x 32	48	54	45
2" x 1-1/2" x 1-1/2"	50 x 40 x 40	50 x 40 x 40	52	55	50
2-1/2" x 2" x 2"	65 x 50 x 50	65 x 50 x 50	61	66	57
3" x 2" x 2"	80 x 50 x 50	80 x 50 x 50	64	73	51

Note: NSF 61 certificate is available for M1210 ~ M1244.